

STUDENT LIFE & ACADEMICS UNDER 5,000 SQ.FT.

DESIGNER: Kara Holland
EMAIL: kmressle@indiana.edu
PHONE NUMBER: 317-408-0571
SCHOOL: Indiana University

ARCHITECTURAL DESIGN FIRM: NA

I HAVE RECEIVED PERMISSION FROM THE ARCHITECT FOR
USE OF PHOTOS OF THEIR WORK TO BE DISPLAYED ON THE
AUID WEBSITE: NA

THIS PAGE WILL NOT BE SHARED WITH THE JUDGES, PLEASE
DO NOT INCLUDE ANY FLOOR PLANS OR PHOTOS ON THIS
PAGE.

IN ORDER TO PRESERVE ANONYMITY WITH THE JUDGES,
THE IDENTITY OF YOUR NAME/INSTITUTION SHOULD NOT BE
IN YOUR DESIGN INTENT STATEMENT OR IN PHOTOS (WHERE
POSSIBLE).

PLEASE EMAIL POWER POINT ENTRY DOCUMENT TO AUID
DESIGN COMPETITION EMAIL:

info@avid.org

STUDENT LIFE & ACADEMICS UNDER 5,000 SQ.FT.

PROJECT TITLE: Eigenmann Library
SQUARE FOOTAGE: 1244 sq.ft.

PROJECT STATEMENT: The library staff wanted to create a cozy environment for students to come check out books or movies, as well as to create a comfortable study place for students to come to within their residence hall. The staff were happy with the previous layout, but wanted to freshen things up and had a small budget to do so. It was important to them to try and attract students to make the library a more used space. The design accomplished their goals by incorporating comfortable and residential feeling materials, new furniture with integrated power, and multiple light sources. The overall budget was \$58,000. A mixture of existing and new furniture was used to stretch their budget. Several different zones were created to allow for different types of studying, reading, or playing games. Storage was moved out of the student space and a central reception area was added.

ACCOMPLISHMENTS OR SPECIAL FEATURES: Tables with integrated lamps and power were added to create a more intimate and functional study environment.

BEFORE



BEFORE



Eigenmann Library



Eigenmann Library

PORTION OF PROJECT DESIGNER IS RESPONSIBLE FOR:

- PROGRAMMING
- BUDGET PREPARATION
- BUDGET MANAGEMENT
- SPACE PLANNING FURNITURE LAYOUT
- FURNITURE SPECIFICATION
- FINISH SPECIFICATION
- GENERAL LIGHTING SPECIFICATION
- SPECIALTY LIGHTING SPECIFICATION
- WALL TREATMENT
- CEILING TREATMENT
- PROJECT COORDINATION AND REVIEW

AFTER

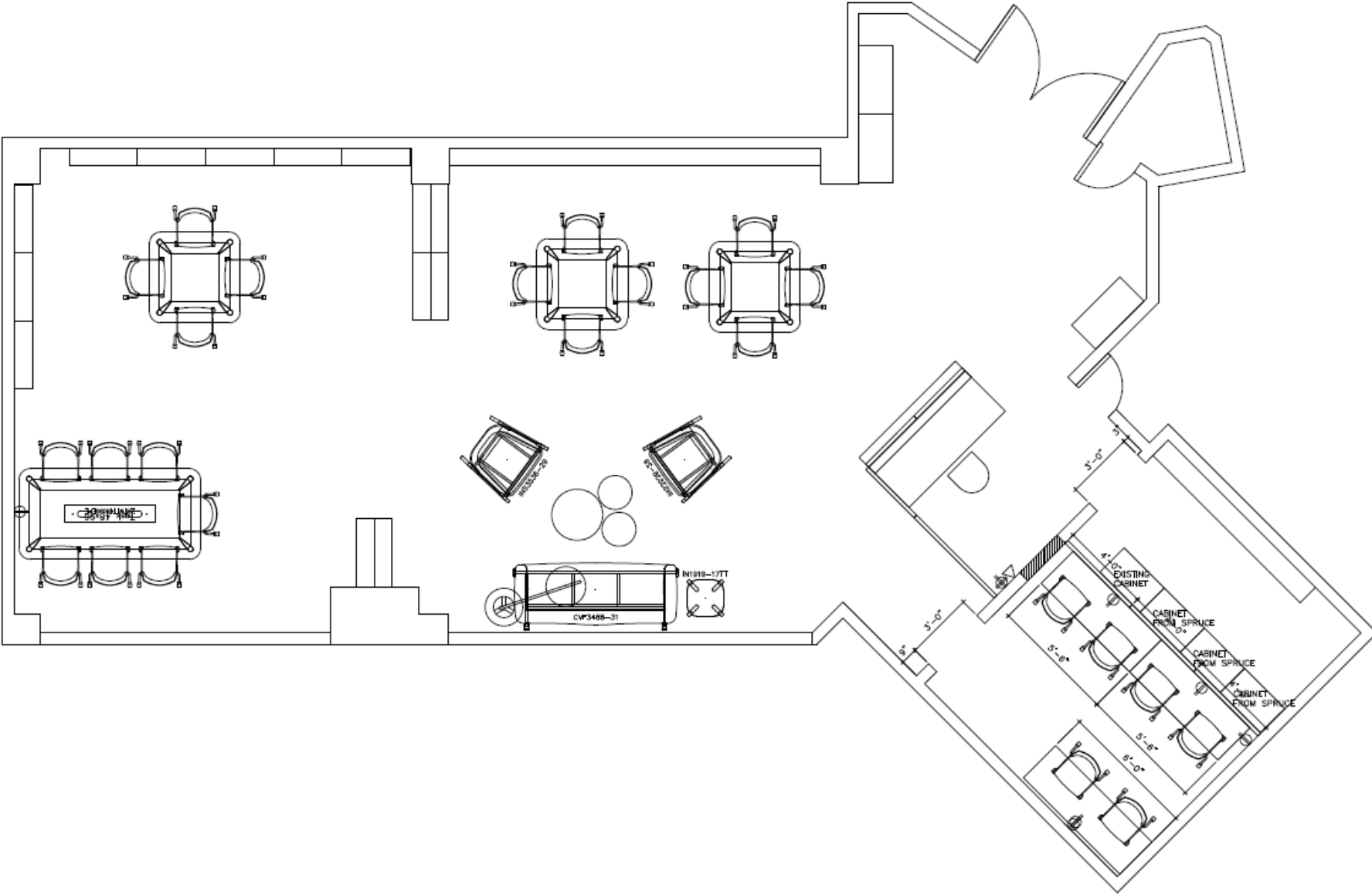

BEFORE

AFTER

FLOOR PLANS

(Maximum of 4 total, between this slide
and previous slide)

*Please move the "Before" AND "After" text
boxes as needed for the plans (may delete
labels if not applicable).