

**MISCELLANEOUS CAMPUS  
SPACES  
UNDER 5,000 SQ.FT.**

**DESIGNER:** Jamie Boynton  
**EMAIL:** jamieboynton@creighton.edu  
**PHONE NUMBER:** 402-510-1966  
**SCHOOL:** Creighton University

I HAVE RECEIVED PERMISSION FROM THE ARCHITECT FOR  
USE OF PHOTOS OF THEIR WORK TO BE DISPLAYED ON THE  
AUID WEBSITE: YES

\*\*\*\*\*

THIS PAGE WILL NOT BE SHARED WITH THE JUDGES, PLEASE  
DO NOT INCLUDE ANY FLOOR PLANS OR PHOTOS ON THIS  
PAGE.

IN ORDER TO PRESERVE ANONYMITY WITH THE JUDGES,  
THE IDENTITY OF YOUR NAME/INSTITUTION SHOULD NOT BE  
IN YOUR DESIGN INTENT STATEMENT OR IN PHOTOS (WHERE  
POSSIBLE).

PLEASE EMAIL POWER POINT ENTRY DOCUMENT TO AUID  
DESIGN COMPETITION EMAIL:

[info@avid.org](mailto:info@avid.org)

\*\*\*\*\*

Our Lady of Montserrat Chapel

## MISCELLANEOUS CAMPUS SPACES UNDER 5,000 SQ.FT.

**PROJECT TITLE:** Our Lady of Montserrat Chapel

**SQUARE FOOTAGE:** 961 SF

**PROJECT BUDGET:** \$712,000

**DID YOU WORK WITH AN OUTSIDE FIRM OR CONSULTANT? IF YES, LIST COMPANY NAME:**

Zongkers Custom Woodworks and ArtStudio 101

### PROJECT DESCRIPTION:

The client desired a space that could accommodate congregational services and reflection, allowing for flexible furniture arrangements. A border was created in the flooring perimeter to allow placement of chairs for quiet reflection. The color scheme aligns with the campus colors, featuring a mix of rich and bright blues complemented by warm wood tones and modern black finishes. Introducing an earth toned quartz with blends of gold, white, and beige for a neutral charm and durability. A mosaic artwork intertwined with blue tones and metallics offer a subtle glow that intensifies as the daylight fades into evening sits above the Credence Table which is for ceremonial purposes.

This project marked my first experience designing with custom liturgical furnishings and artwork for a 961 square foot chapel. The main challenge for this project was timing, the chapel was the last area completed in the construction phased plan. Additionally, there was pressure on the timeline due to last-minute changes in interior finishes and the need to collaborate with vendors on design of liturgical items and artwork but made it to the finish line in time for grand opening ceremonies. The total budget for furniture and finishes was approximately \$103,000.



Our Lady of Montserrat Chapel

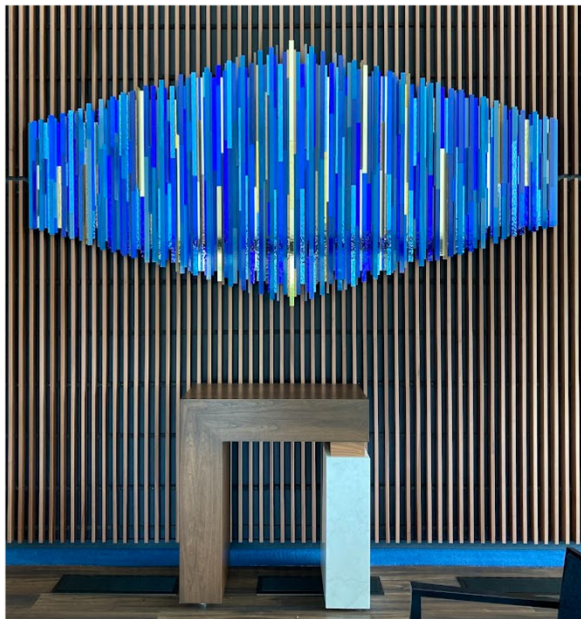

Our Lady of Montserrat Chapel

**PORTION OF PROJECT DESIGNER IS RESPONSIBLE FOR:**

- BUDGET PREPARATION
- BUDGET MANAGEMENT
- SPACE PLANNING FURNITURE LAYOUT
- FURNITURE SPECIFICATION
- FINISH SPECIFICATION
- SPECIALTIES:
  - CUSTOM LITURGICAL FURNISHINGS
  - CUSTOM ARTWORK
- PROJECT COORDINATION AND REVIEW

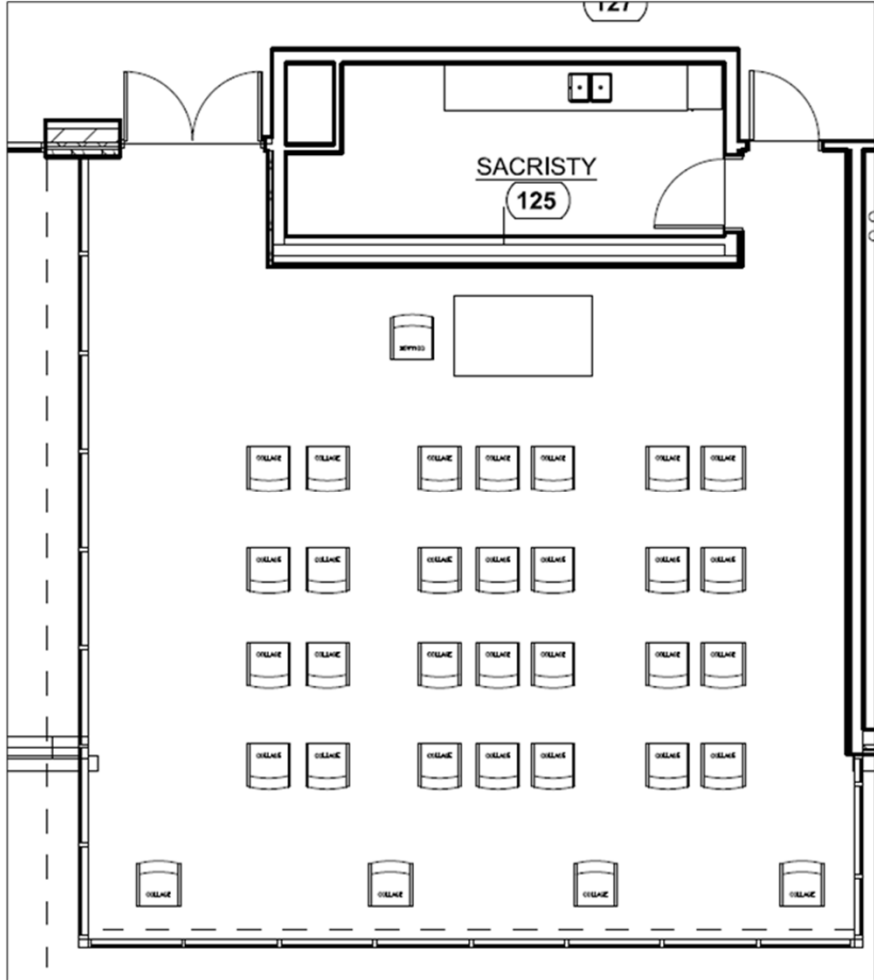

Our Lady of Montserrat Chapel

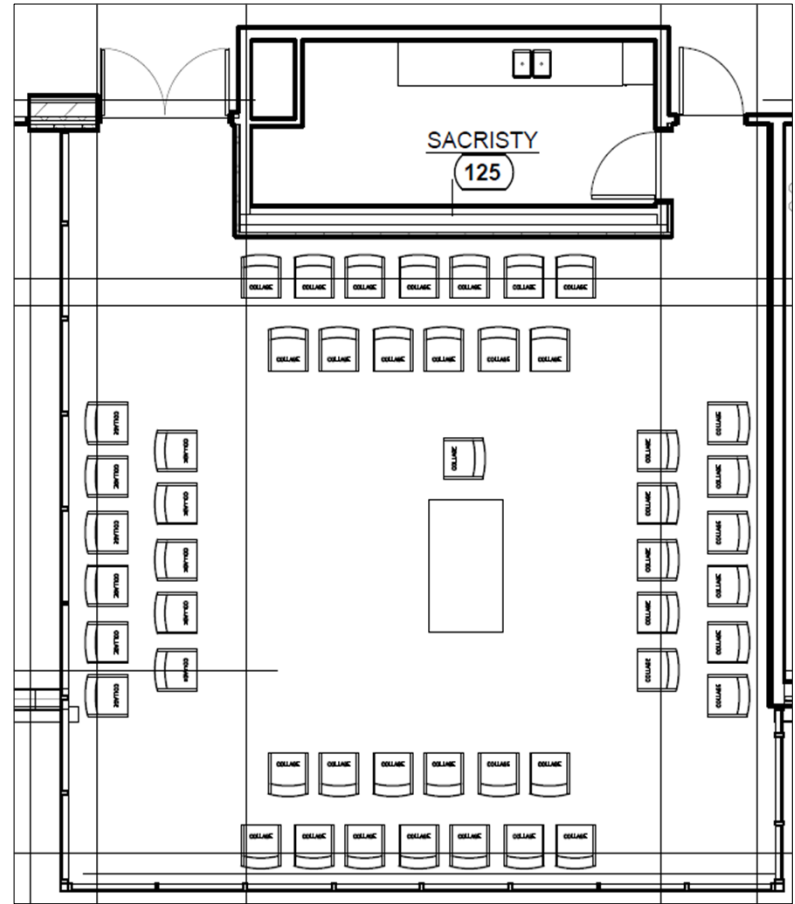
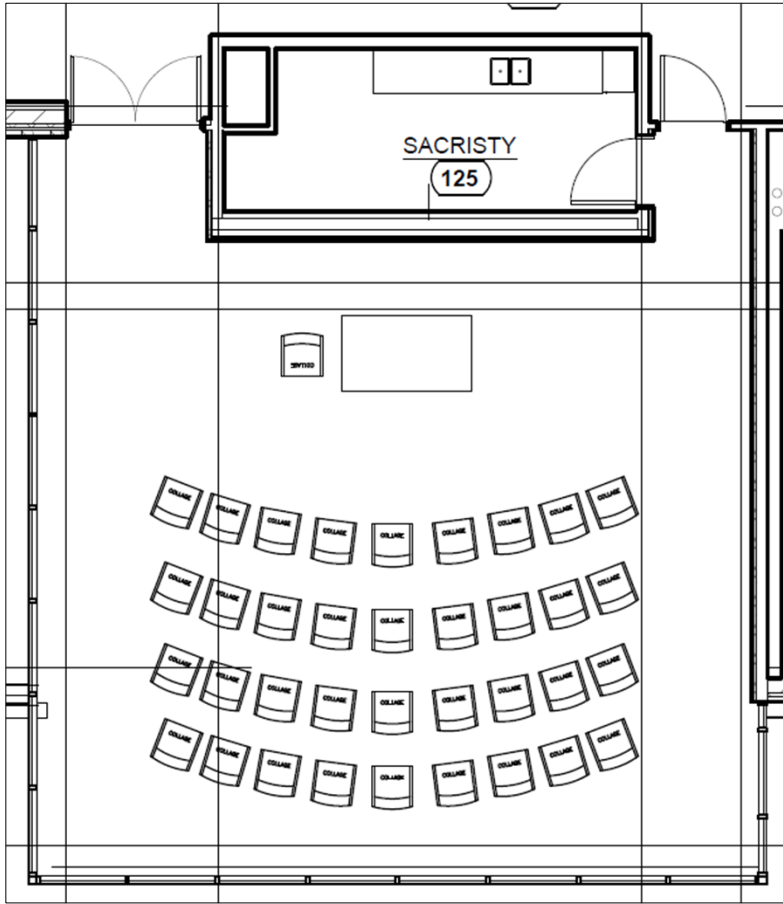

Our Lady of Montserrat Chapel