

STUDENT LIFE & ACADEMICS
5,000-20,000 SQ.FT.

DESIGNER: Jennifer Catalano
EMAIL: jecatala@umich.edu
PHONE NUMBER: 734-647-2705
SCHOOL: University of Michigan

I HAVE RECEIVED PERMISSION FROM THE ARCHITECT FOR
USE OF PHOTOS OF THEIR WORK TO BE DISPLAYED ON THE
AUID WEBSITE: N/A – Photos taken by Michigan Photography

THIS PAGE WILL NOT BE SHARED WITH THE JUDGES, PLEASE
DO NOT INCLUDE ANY FLOOR PLANS OR PHOTOS ON THIS
PAGE.

IN ORDER TO PRESERVE ANONYMITY WITH THE JUDGES,
THE IDENTITY OF YOUR NAME/INSTITUTION SHOULD NOT BE
IN YOUR DESIGN INTENT STATEMENT OR IN PHOTOS (WHERE
POSSIBLE).

PLEASE EMAIL POWER POINT ENTRY DOCUMENT TO AUID
DESIGN COMPETITION EMAIL:

info@avid.org

STUDENT LIFE & ACADEMICS 5,000-20,000 SQ.FT.

PROJECT TITLE: Inn at Michigan League Updates

SQUARE FOOTAGE: ~9,500

PROJECT BUDGET: \$233,000

DID YOU WORK WITH AN OUTSIDE FIRM OR CONSULTANT? IF

YES, LIST COMPANY NAME: N/A

PROJECT DESCRIPTION:

The Inn at Michigan League, a 21-room on-campus hotel located on the top floor of a historic University Union building, recently underwent a significant refresh. This renovation aimed to modernize the hotel's appearance while honoring its unique historical features, including dormer windows, intricate woodwork and varied ceiling heights in each room.

The renovation project faced notable challenges, primarily due to the concurrent full elevator replacement, which shut down the elevator for three months. This complication required completing the renovation in under 90 days including material lead time challenges without the use of a passenger elevator. Additionally, furniture and other items had to be temporarily stored in rooms while the work was going on, adding to the complexity of the project.

The design strategy focused on updating the hotel's aesthetic to feel more contemporary and collegiate, while still preserving its historical charm. The scope of work included refreshing the existing colors and finishes, along with new flooring and painting. A key aspect of the renovation was consolidating vending services into a single area rather than having them spread out across the corridors, which helped streamline the space and improve guest convenience.

Given the limited time and budget, design decisions were made quickly but thoughtfully. The refresh featured a modern color palette that complements the building's historic features, blending contemporary finishes with classic details. This approach ensured that the hotel felt both updated and in harmony with its historic setting.

I was responsible for all design specification, managing and reviewing the project schedule and coordinating with various trades to ensure timely completion. Despite the constraints, the renovation successfully balanced modern updates with the preservation of historical elements, resulting in a refreshed hotel that meets contemporary standards while respecting its unique character.



BEFORE



Inn at Michigan League Updates



AFTER

Inn at Michigan League Updates

PORTION OF PROJECT DESIGNER IS RESPONSIBLE FOR:

- PROGRAMMING
- BUDGET PREPARATION
- BUDGET MANAGEMENT
- FINISH SPECIFICATION
- WALL TREATMENT
- MILLWORK-CUSTOM CASE PIECE DESIGN
- SPECIALTIES: CARPET/FLOORING DESIGN (HOSPITALITY CARPET), CUSTOM SHELVING DESIGN
- PROJECT COORDINATION AND REVIEW



BEFORE

Inn at Michigan League Updates

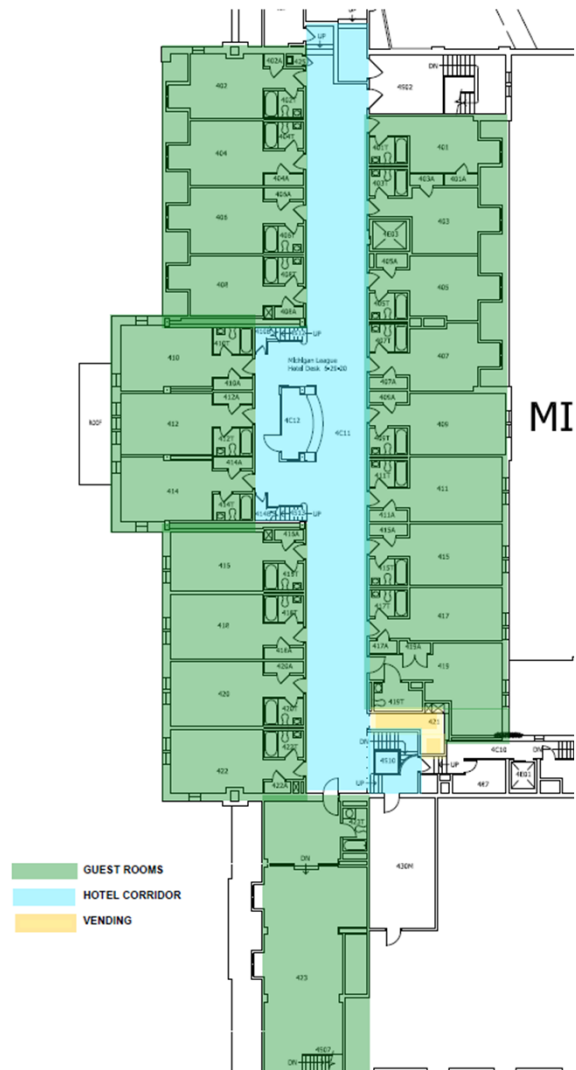

AFTER – SCOPE PLAN

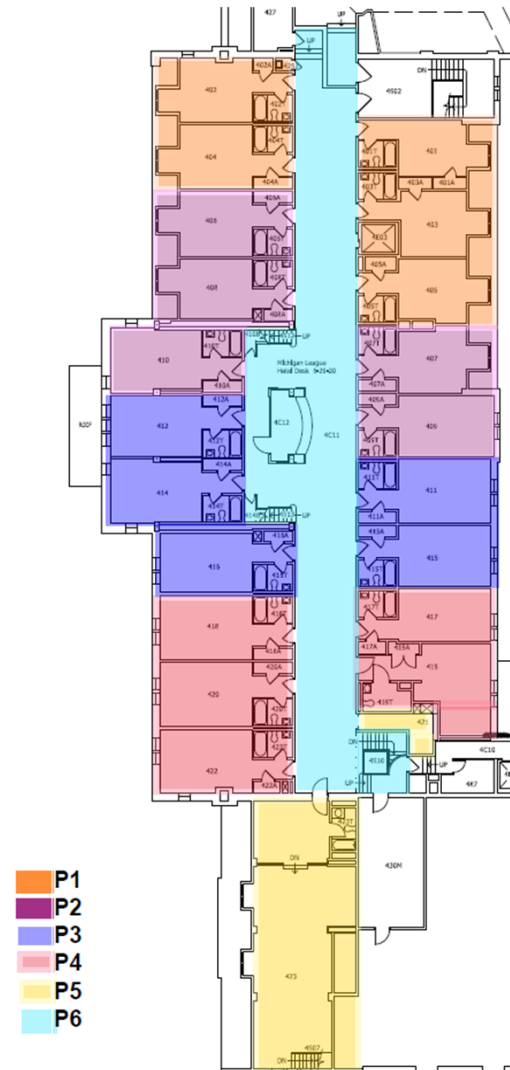

AFTER – 60-day PHASING PLAN