

STUDENT LIFE & ACADEMICS 5,000-20,000 SQ.FT.

DESIGNER: Melissa Marriott and Kate Mechling

EMAIL: mmarriot@illinois.edu

PHONE NUMBER: 217-202-2281

SCHOOL: University of Illinois

I HAVE RECEIVED PERMISSION FROM THE ARCHITECT FOR
USE OF PHOTOS OF THEIR WORK TO BE DISPLAYED ON THE
AUID WEBSITE: (YES/NO) N/A

THIS PAGE WILL NOT BE SHARED WITH THE JUDGES, PLEASE
DO NOT INCLUDE ANY FLOOR PLANS OR PHOTOS ON THIS
PAGE.

IN ORDER TO PRESERVE ANONYMITY WITH THE JUDGES,
THE IDENTITY OF YOUR NAME/INSTITUTION SHOULD NOT BE
IN YOUR DESIGN INTENT STATEMENT OR IN PHOTOS (WHERE
POSSIBLE).

PLEASE EMAIL POWER POINT ENTRY DOCUMENT TO AUID
DESIGN COMPETITION EMAIL:

info@auid.org

STUDENT LIFE & ACADEMICS

5,000-20,000 SQ.FT.

PROJECT TITLE: Pennsylvania Ave Res Hall Lobby Remodel
SQUARE FOOTAGE: 7,955 sq. ft.
PROJECT BUDGET: \$400,000
DID YOU WORK WITH AN OUTSIDE FIRM OR CONSULTANT? IF YES, LIST COMPANY NAME: No

PROJECT DESCRIPTION: Project scope was to update lobby finishes and remodel area office spaces to increase customer service and create a more functional package sorting station. Before remodel, staff was seated at a desk configuration separate from the service openings, security gates had to be manually pulled down each night (usually by climbing on counter) and packages were sorted into boxes on the floor. There were two 30" door entries into the office and one of those entries would potentially block the desk supervisor from getting into their office.

Flooring and wall finishes were bland and offered no school branding to the entry. Walnut plank walls were original to the building from 1965 and gave a very dated feel. Bench seating was worn down and uncomfortable. Resident directors had very narrow offices that only allowed for them to meet with students while seated at their desks.

Designers created a single accessible entry door into area office directly across from the ramp into custom built package sorting island. Security gates at customer service windows were motorized and depth of service windows was extended to allow for staff of any ability to easily work at area office. Desk Supervisor office was relocated while still allowing sightlines into the area office space.

Resident Director offices were expanded to allow for meeting table spaces along with the addition of desk space for office assistants. Flooring was updated to a large format rubber tile to cut down on the necessary maintenance time and brighten the space. Wall finishes and updated textiles at seating allowed for implementation of school brand colors within the space.

BEFORE



AFTER



BEFORE



AFTER





AFTER



Pennsylvania Ave Res Hall Lobby Remodel

PORTION OF PROJECT DESIGNER IS RESPONSIBLE FOR:

- PROGRAMMING
- BUDGET PREPARATION
- BUDGET MANAGEMENT
- ARCHITECTURAL DRAWINGS/DESIGN (VERIFIED BY IN-HOUSE ARCHITECT)
- SPACE PLANNING FURNITURE LAYOUT
- FURNITURE SPECIFICATION
- FINISH SPECIFICATION
- WINDOW TREATMENT SPECIFICATION
- WALL TREATMENT
- GENERAL SIGNAGE
- SPECIALTY SIGNAGE
- MILLWORK-CUSTOM CASE PIECE DESIGN
- PROJECT COORDINATION AND REVIEW

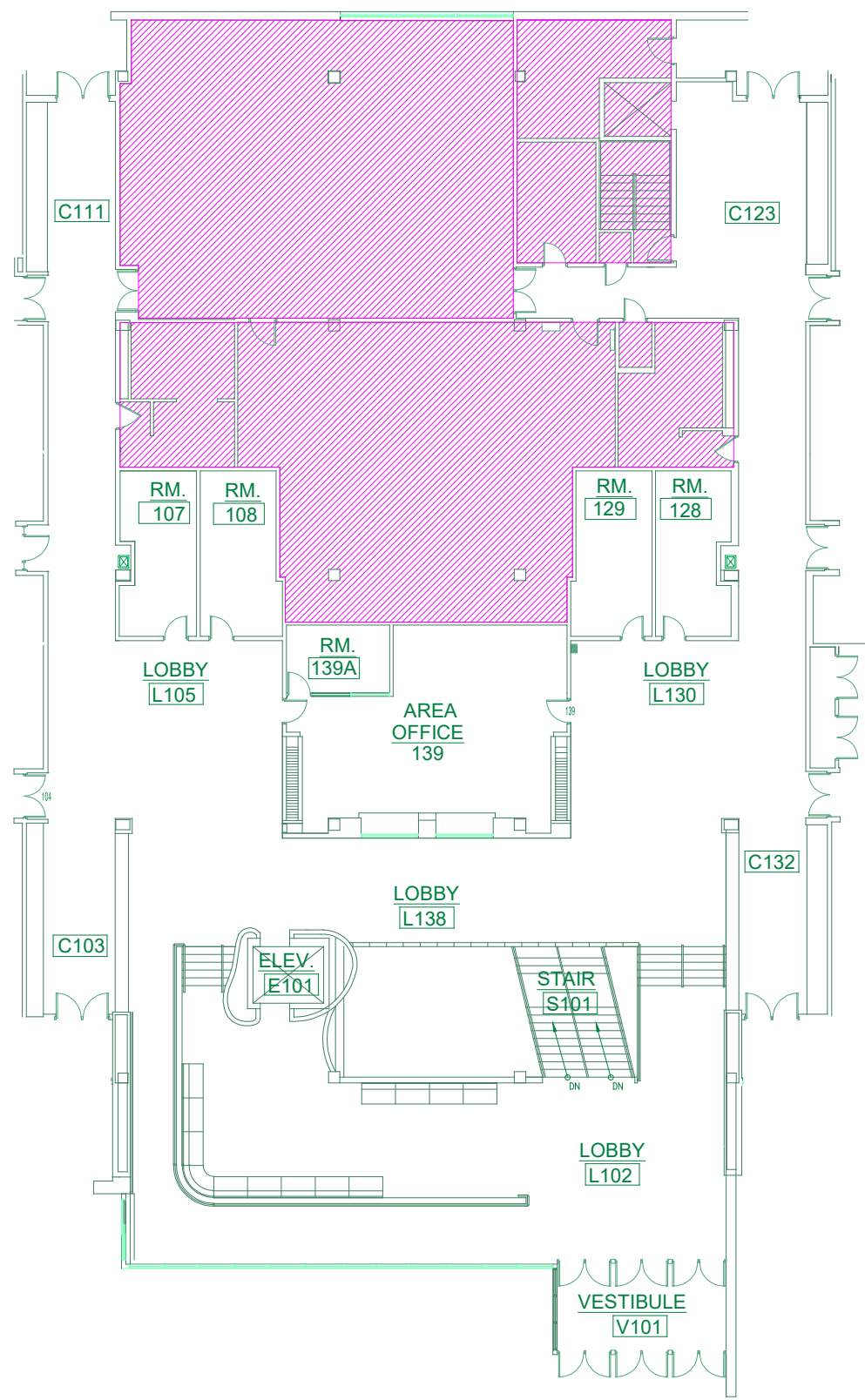

BEFORE

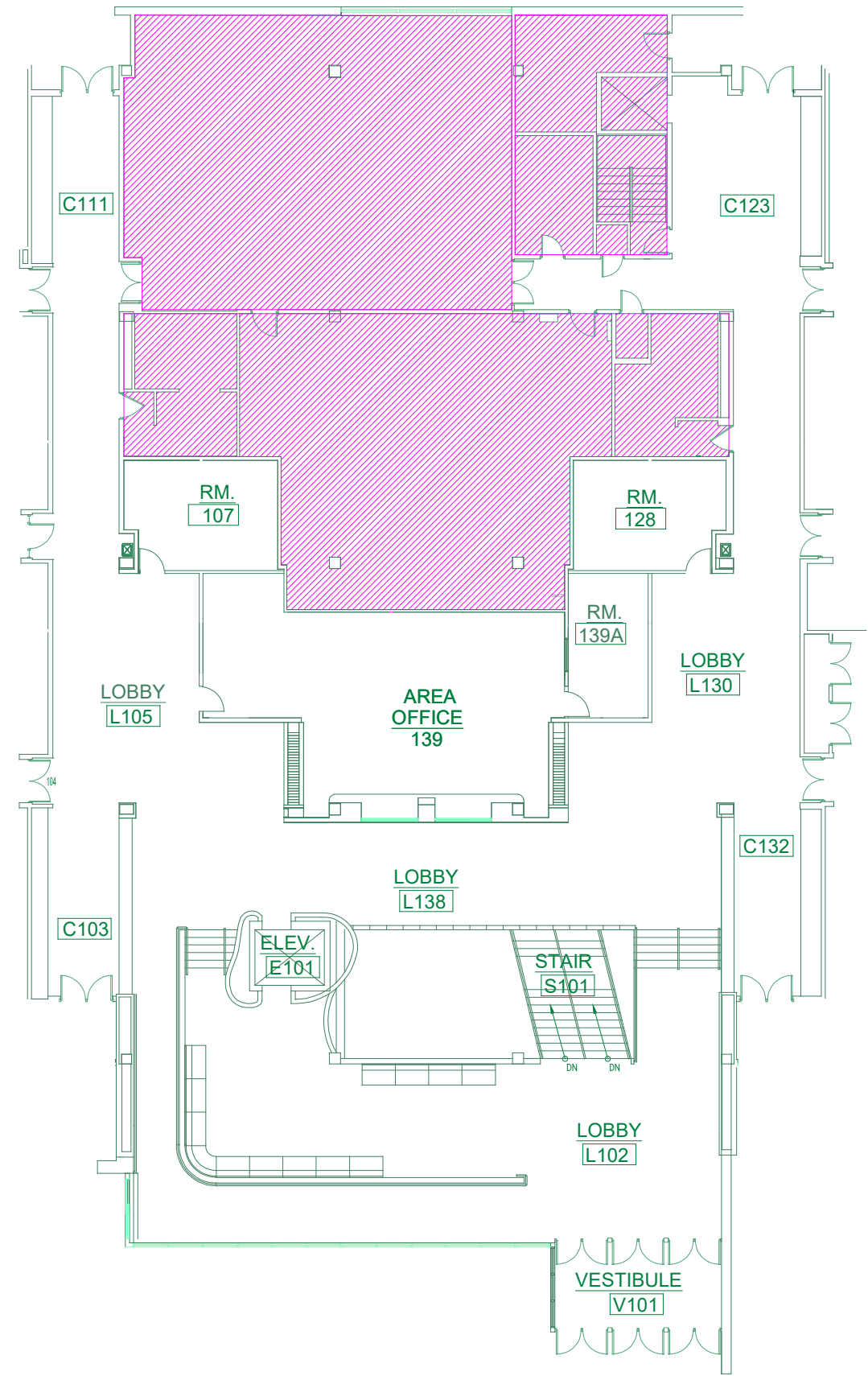

AFTER

Pennsylvania Ave Res Hall Lobby Remodel