

STUDENT LIFE & ACADEMICS UNDER 5,000 SQ.FT.

DESIGNER: Stefanie Locklear
EMAIL: stefan8@vt.edu
PHONE NUMBER: 540-231-2028
SCHOOL: Virginia Tech

I HAVE RECEIVED PERMISSION FROM THE ARCHITECT FOR
USE OF PHOTOS OF THEIR WORK TO BE DISPLAYED ON THE
AUID WEBSITE: Yes-no architect on project

THIS PAGE WILL NOT BE SHARED WITH THE JUDGES, PLEASE
DO NOT INCLUDE ANY FLOOR PLANS OR PHOTOS ON THIS
PAGE.

IN ORDER TO PRESERVE ANONYMITY WITH THE JUDGES,
THE IDENTITY OF YOUR NAME/INSTITUTION SHOULD NOT BE
IN YOUR DESIGN INTENT STATEMENT OR IN PHOTOS (WHERE
POSSIBLE).

PLEASE EMAIL POWER POINT ENTRY DOCUMENT TO AUID
DESIGN COMPETITION EMAIL:

info@avid.org

STUDENT LIFE & ACADEMICS UNDER 5,000 SQ.FT.

PROJECT TITLE: Torgersen 3100 Classroom

SQUARE FOOTAGE: 3,300

PROJECT BUDGET: \$470,000

DID YOU WORK WITH AN OUTSIDE FIRM OR CONSULTANT? IF YES, LIST COMPANY NAME: Yes, Virginia School Equipment

This tiered classroom in Torgersen Hall was in need of an update aesthetically and functionally. Room 3100 had fixed tables with attached chairs that were installed when the building was completed in 2000. The university has been working hard to create accessible and equitable spaces everywhere on campus, and this renovation helped achieve some of those goals. For this project, we installed new fixed seating with tablets that can be pulled up from the side and provided seats in three different sizes. We updated the flooring throughout the whole room and installed new fabric on the acoustic panels in the back of the room. I chose finishes that reflected our school's brand colors and meshed with the purple and gray color scheme throughout the rest of the building. Overall, I think many upgrades were produced and the room functions better by providing more variety and seats that are easier to enter.

BEFORE

AFTER



Torgersen 3100



BEFORE



AFTER

Torgersen 3100



PORTION OF PROJECT DESIGNER IS RESPONSIBLE FOR:

- FURNITURE SPECIFICATION
- FINISH SPECIFICATION
- WALL TREATMENT
- SPECIALTIES: CUSTOM DETAILS (LIST)
- PROJECT COORDINATION AND REVIEW

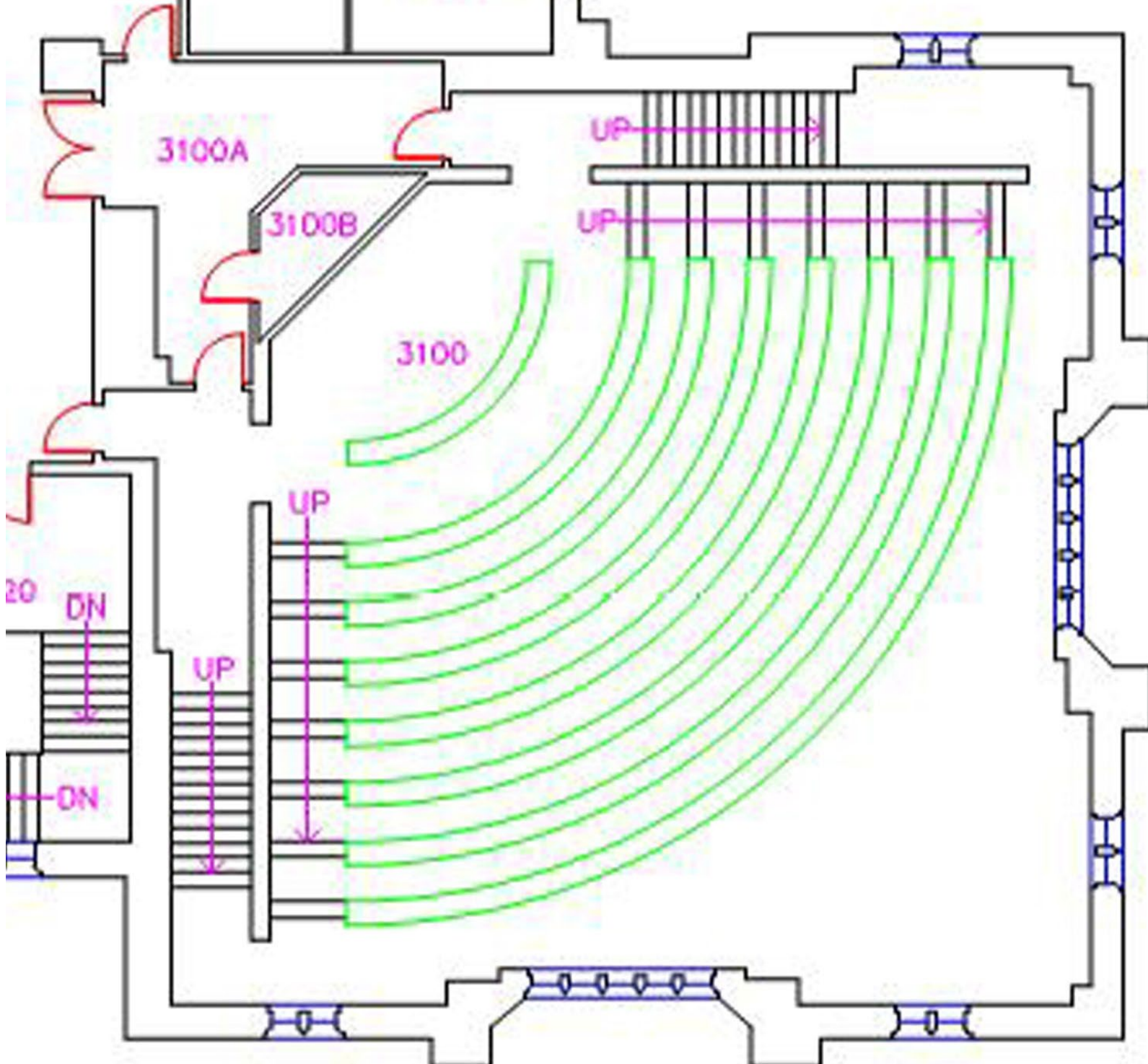

Torgersen 3100