

SPECIALTY

DESIGNER: Stefanie Locklear

EMAIL: stefan8@vt.edu

PHONE NUMBER: 540-231-2028

SCHOOL: Virginia Tech

I HAVE RECEIVED PERMISSION FROM THE ARCHITECT FOR USE OF PHOTOS OF THEIR WORK TO BE DISPLAYED ON THE AUID WEBSITE: No architect was used on this project, VT gives permission for use of photos on the AUID website

THIS PAGE WILL NOT BE SHARED WITH THE JUDGES, PLEASE DO NOT INCLUDE ANY FLOOR PLANS OR PHOTOS ON THIS PAGE.

IN ORDER TO PRESERVE ANONYMITY WITH THE JUDGES, THE IDENTITY OF YOUR NAME/INSTITUTION SHOULD NOT BE IN YOUR DESIGN INTENT STATEMENT OR IN PHOTOS (WHERE POSSIBLE).

PLEASE EMAIL POWER POINT ENTRY DOCUMENT TO AUID DESIGN COMPETITION EMAIL:

info@avid.org

Torgersen Bridge Carpet

SPECIALTY

PROJECT TITLE: Torgersen Bridge Re-Carpeting

SQUARE FOOTAGE: 7,750

PROJECT BUDGET: \$70,000

DID YOU WORK WITH AN OUTSIDE FIRM OR CONSULTANT? IF YES, LIST COMPANY NAME: No

The Torgersen Bridge is an iconic spot on our campus, spanning across Alumni Mall Road and connecting Newman Library to Torgersen Hall. It's a 24-hour quiet space where students study and becomes extra popular during exam time.

The two big reasons for updating this space were 1) the carpet was original to the building (20+ year old Powerbond product) and was showing some wear and 2) the University's logo had changed. As this is a prominent place on campus, University Branding wished to put the new logo into the new carpet.

I worked with Tarkett to create the logo in Powerbond using two solid colors that reflected our brand quite well, and used a different pattern of Powerbond to create the field of carpet with an accent in the main walking path. It took a lot of effort to get all the drawings and colors approved and sized, plus coordinating the furniture move and timing the project over an academic break, BUT the result was well worth it. Overall, the space seems warmer and refreshed. Everyone has been very pleased with the end product and we know the Powerbond can stand the test of time.

BEFORE

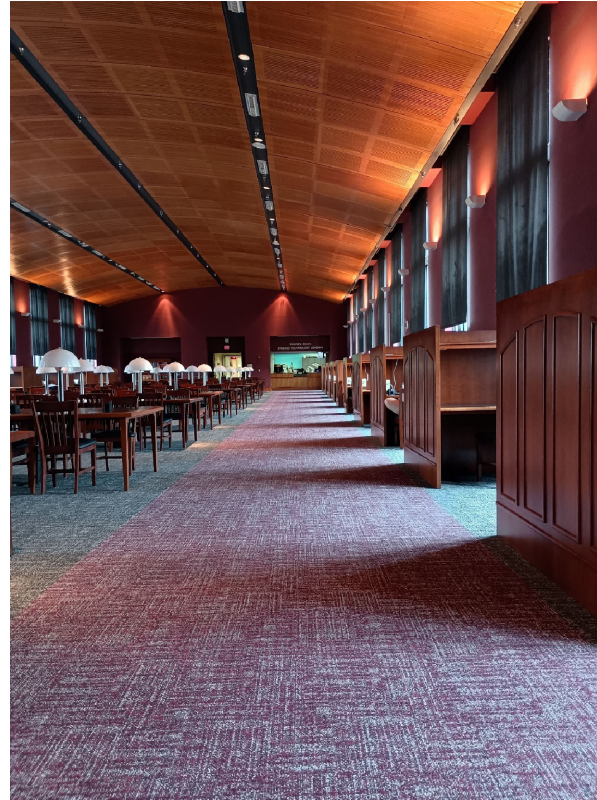

Torgersen Bridge Carpet



AFTER

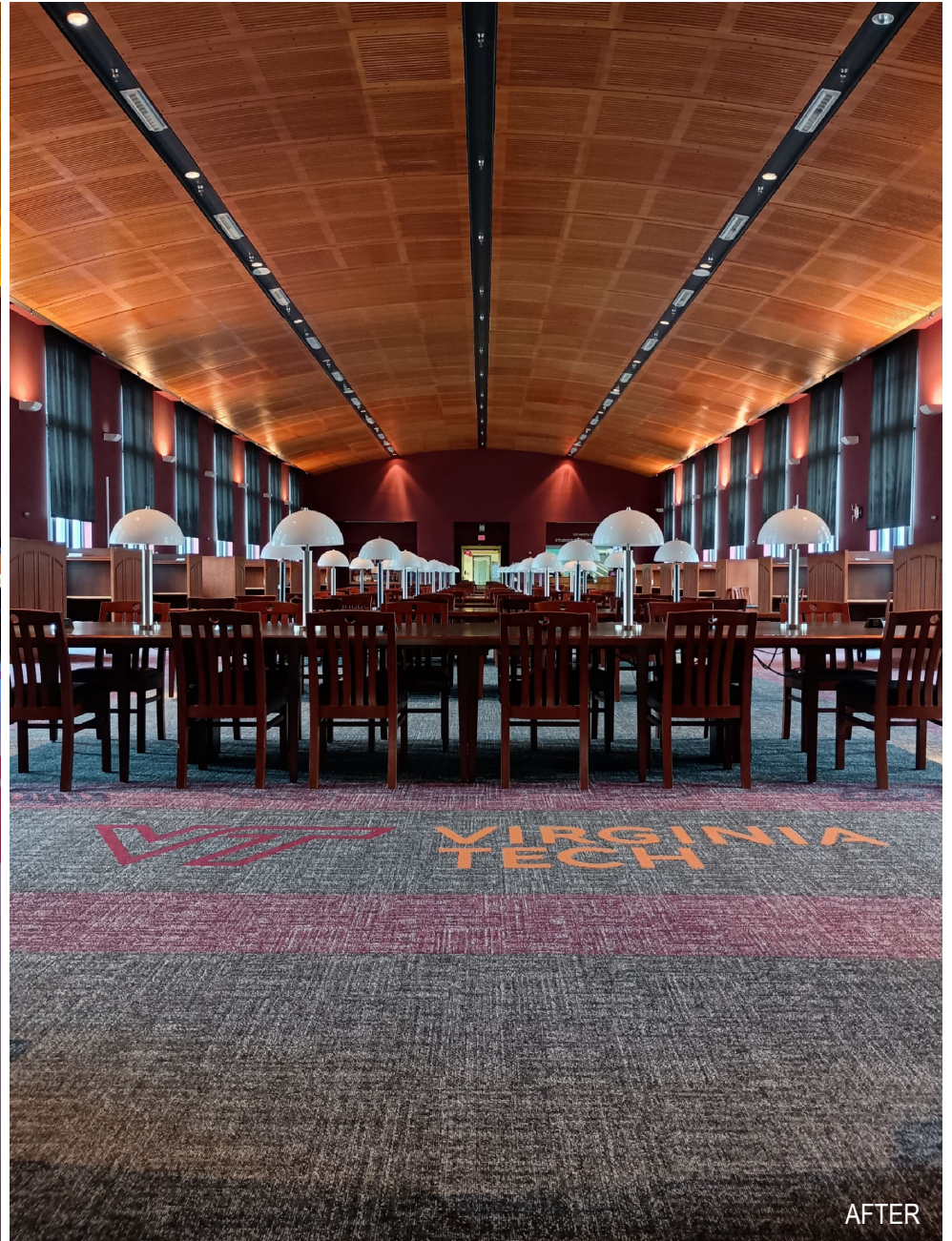

Torgersen Bridge Carpet

PORTION OF PROJECT DESIGNER IS RESPONSIBLE FOR:

- PROGRAMMING
- BUDGET PREPARATION
- BUDGET MANAGEMENT
- FINISH SPECIFICATION
- SPECIALTY SIGNAGE
- SPECIALTIES: CUSTOM DETAILS
 - Custom logo in carpeting
- PROJECT COORDINATION AND REVIEW

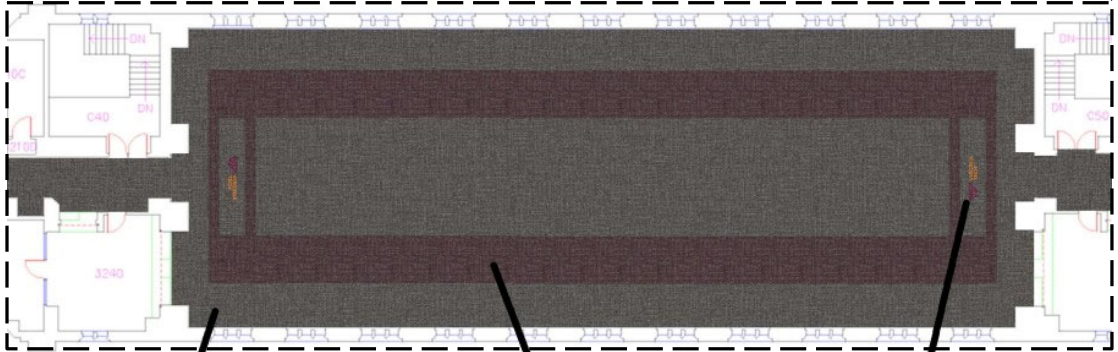
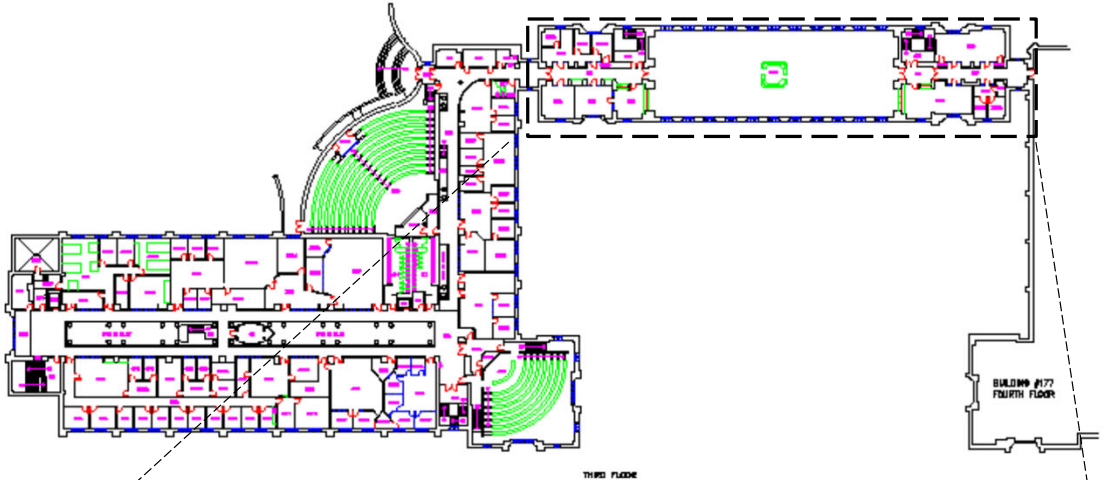

GeoKnit
Saturated Grey

ColorKnit
Deep Raspberry

VT logo in
Plexus Concord Grape
Plexus Orange Julius

Torgersen Bridge Carpet